



Installation instructions, accessories

Volvo Car Corporation Gothenburg, Sweden

Instruction No	Version	Part. No.
31439014	1.0	31373978

Sun curtain, rear window



Installation instructions, accessories

Volvo Car Corporation Gothenburg, Sweden

Equipment



IMG-239667



IMG-397698

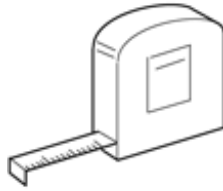

IMG-244945

A

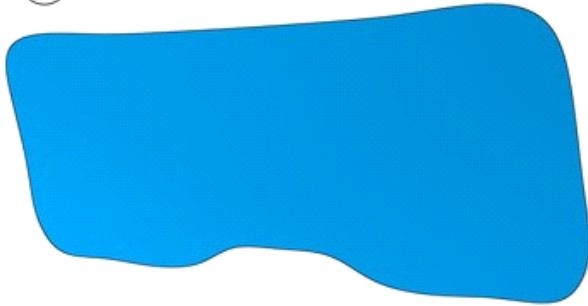

B

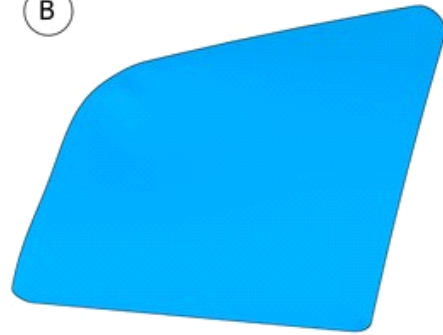

C

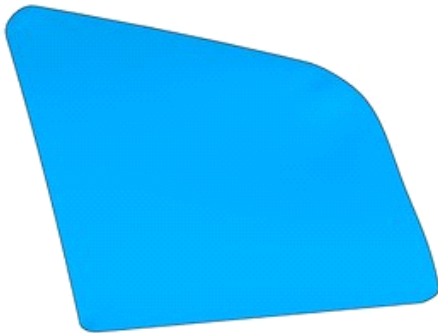

IMG-397786

D

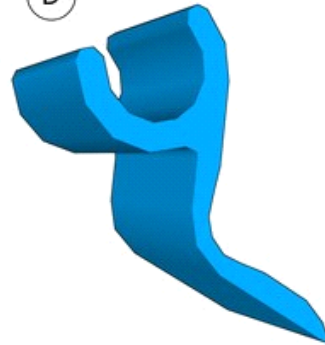

x9



Installation instructions, accessories

Volvo Car Corporation Gothenburg, Sweden

Information

1

Read through all of the instructions before starting installation.

Notifications and warning texts are for your safety and to minimise the risk of something breaking during installation.

Ensure that all tools stated in the instructions are available before starting installation.

Certain steps in the instructions are only presented in the form of images. Explanatory text is also given for more complicated steps.

In the event of any problems with the instructions or the accessory, contact your local Volvo dealer.

Accessory installation

2



IMG-384915



Installation instructions, accessories

Volvo Car Corporation Gothenburg, Sweden

3



IMG-397790

Note!
Orientation view

4



IMG-397690

Use tape

5

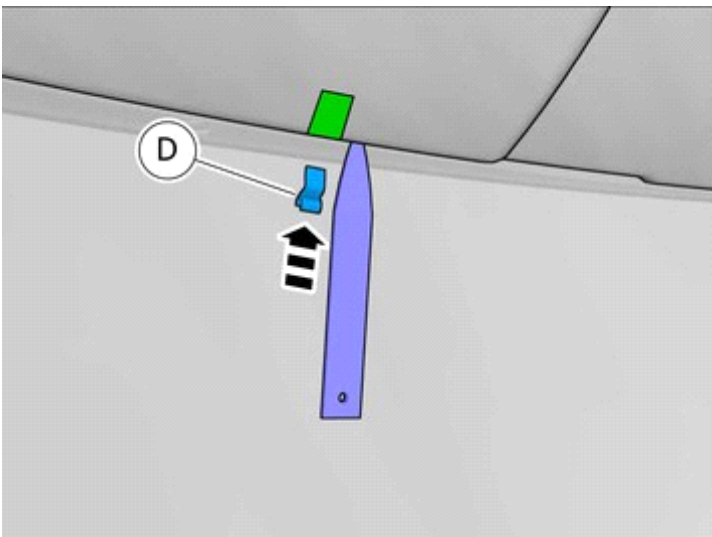

IMG-397685

Install component that comes with the accessory kit.

Use: Interior trim remover



Installation instructions, accessories

Volvo Car Corporation Gothenburg, Sweden

6

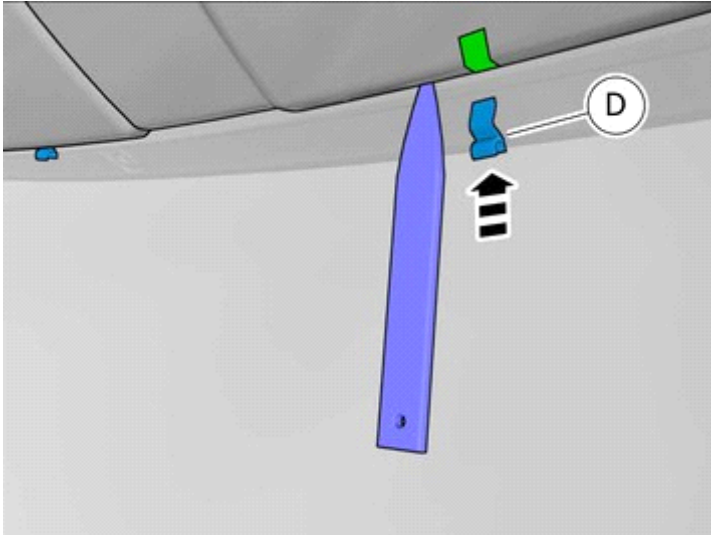

IMG-397686

Install component that comes with the accessory kit.

Use: Interior trim remover

7

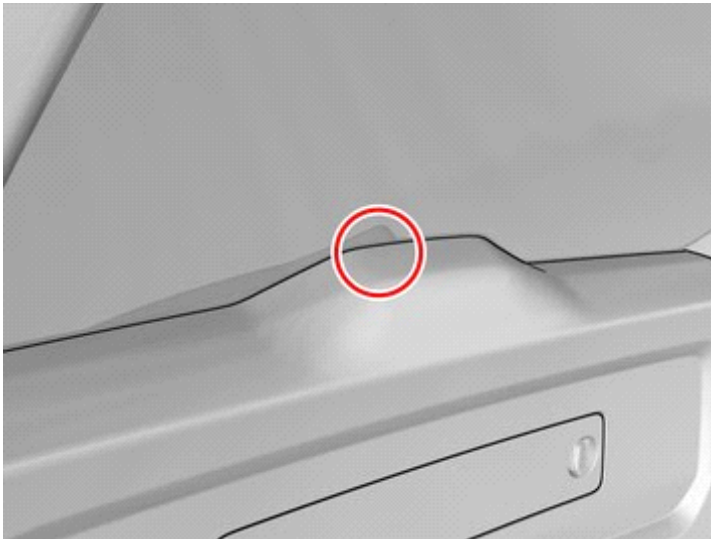

IMG-397701

8

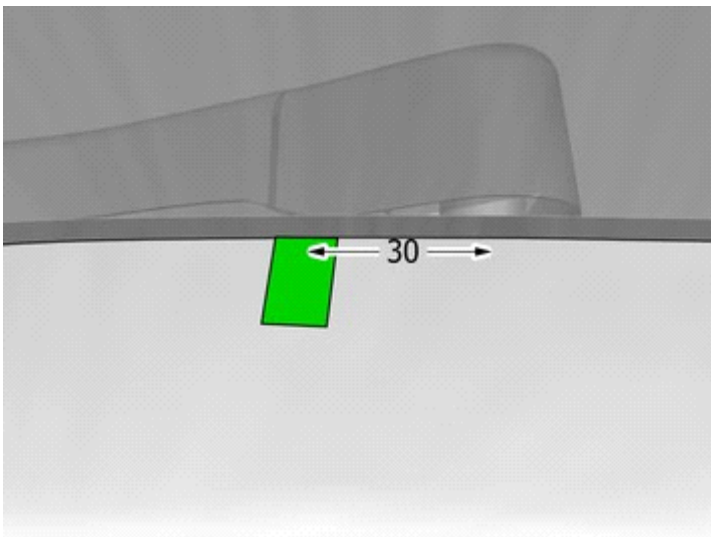

IMG-397700

Use tape



Installation instructions, accessories

Volvo Car Corporation Gothenburg, Sweden

9

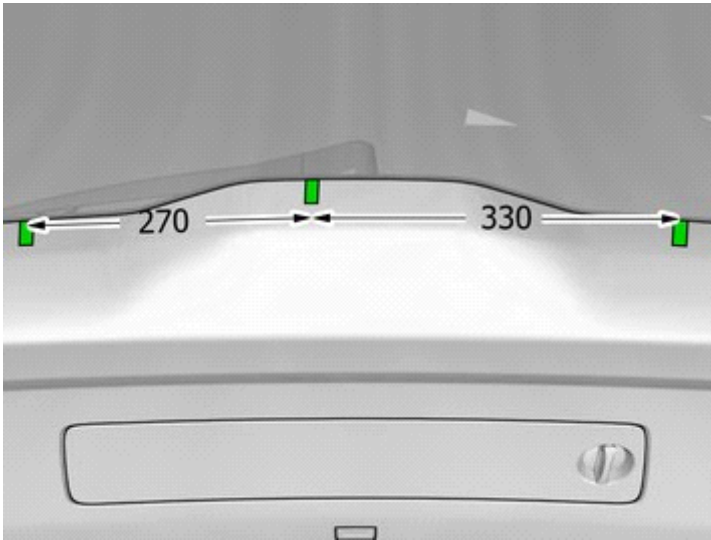

IMG-397703

Use tape

10

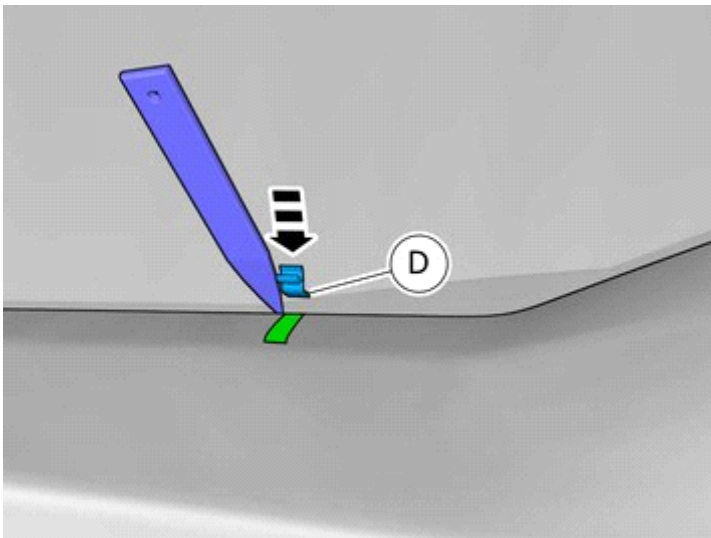

IMG-397706

Install component that comes with the accessory kit.



Installation instructions, accessories

Volvo Car Corporation Gothenburg, Sweden

11

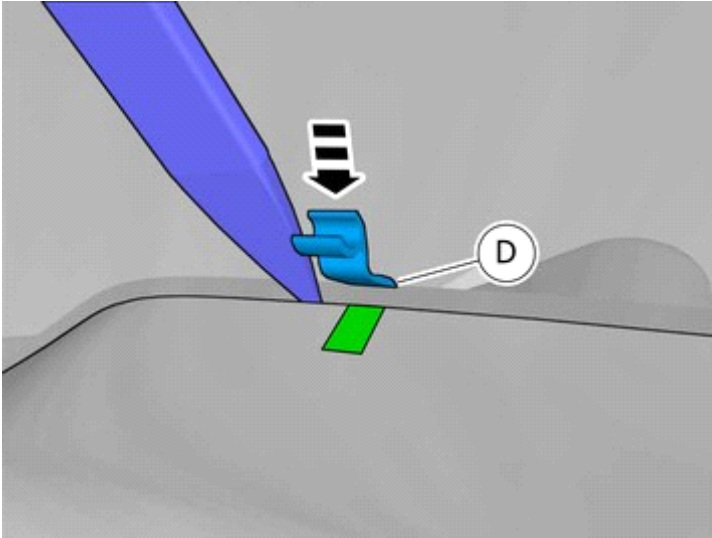

IMG-397707

Install component that comes with the accessory kit.

12

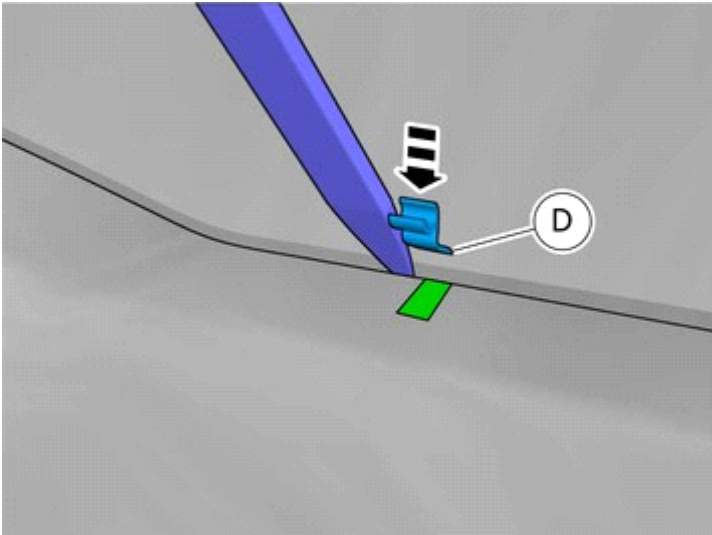

IMG-397708

Install component that comes with the accessory kit.

13

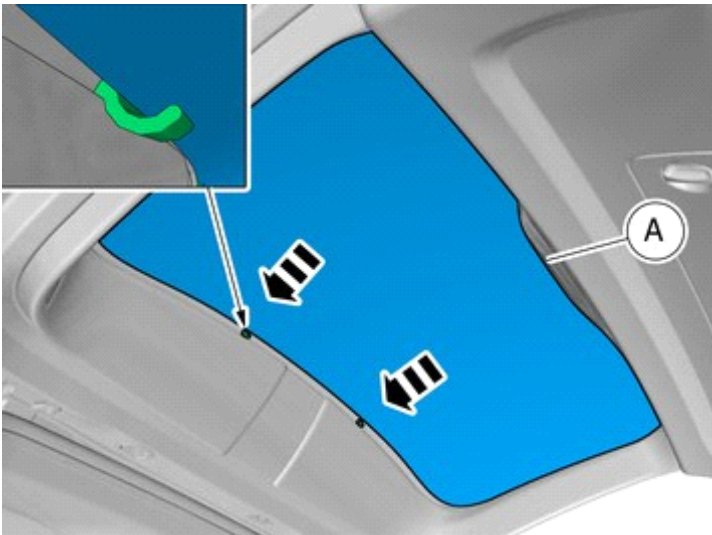

IMG-397733

Install component that comes with the accessory kit.



Installation instructions, accessories

Volvo Car Corporation Gothenburg, Sweden

14

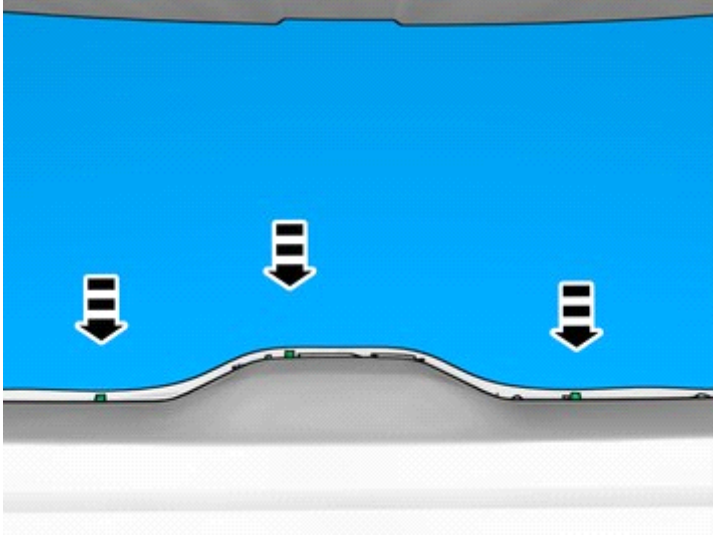

IMG-397732

Ensure that all clips engage.

15



IMG-397766

Note!
Orientation view

16



IMG-397765

Use tape



Installation instructions, accessories

Volvo Car Corporation Gothenburg, Sweden

17

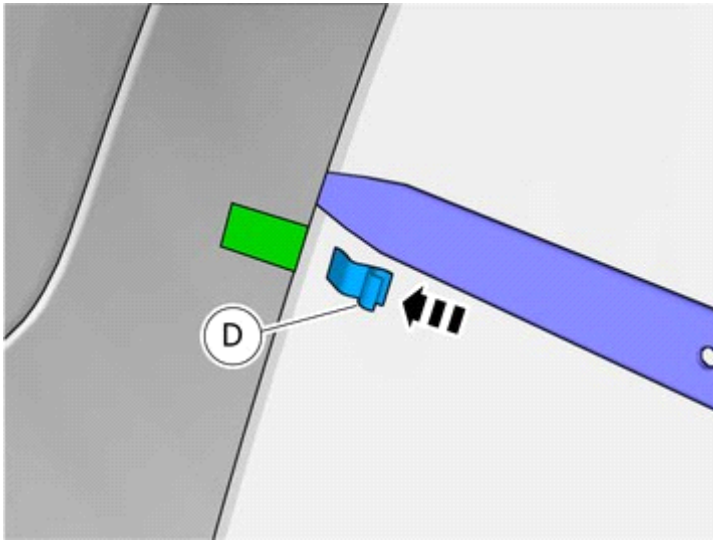

IMG-397768

Install component that comes with the accessory kit.

18

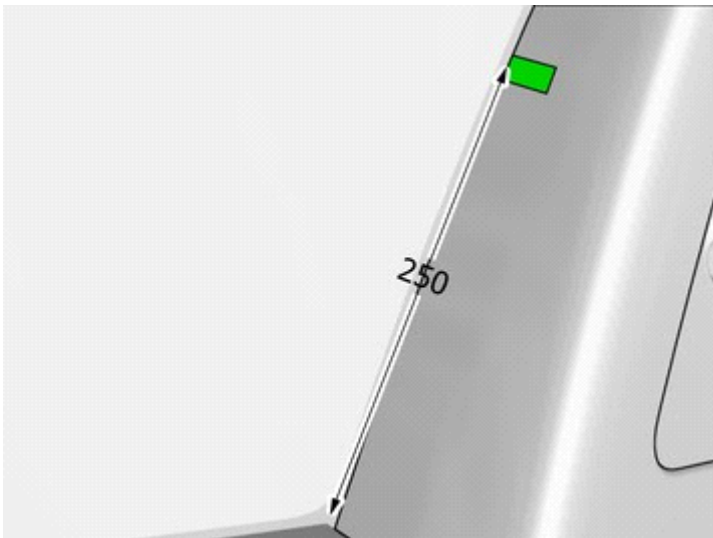

IMG-397771

Use tape



Installation instructions, accessories

Volvo Car Corporation Gothenburg, Sweden

19

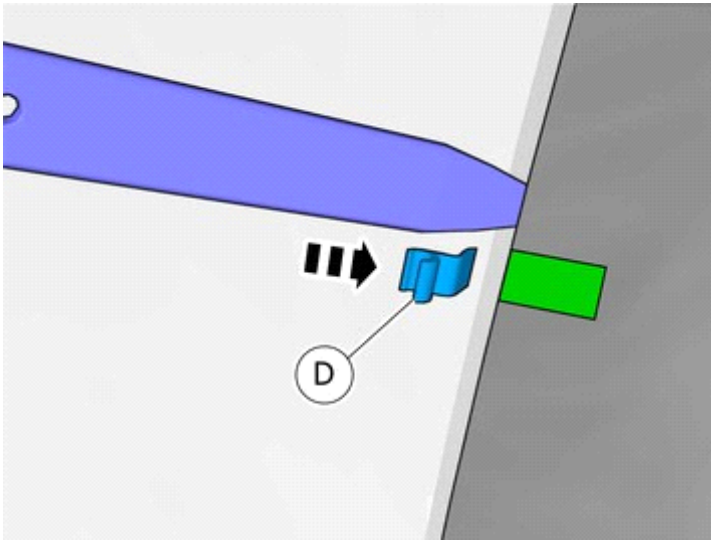

IMG-397772

Install component that comes with the accessory kit.

20

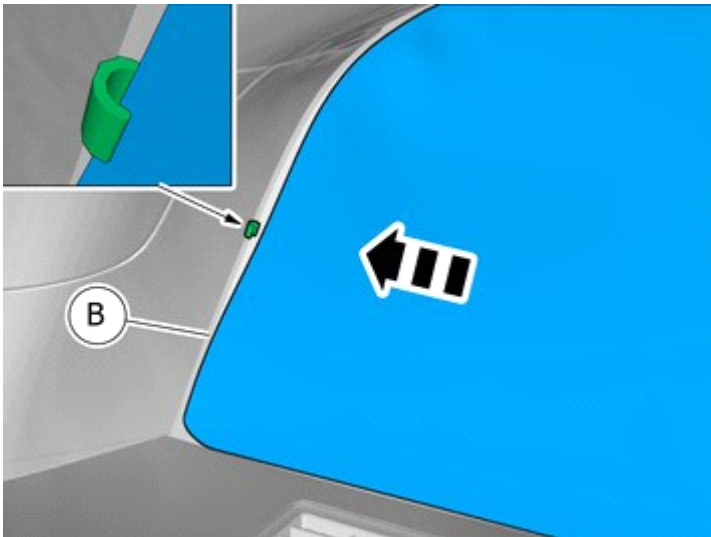

IMG-397780

Install component that comes with the accessory kit.

21

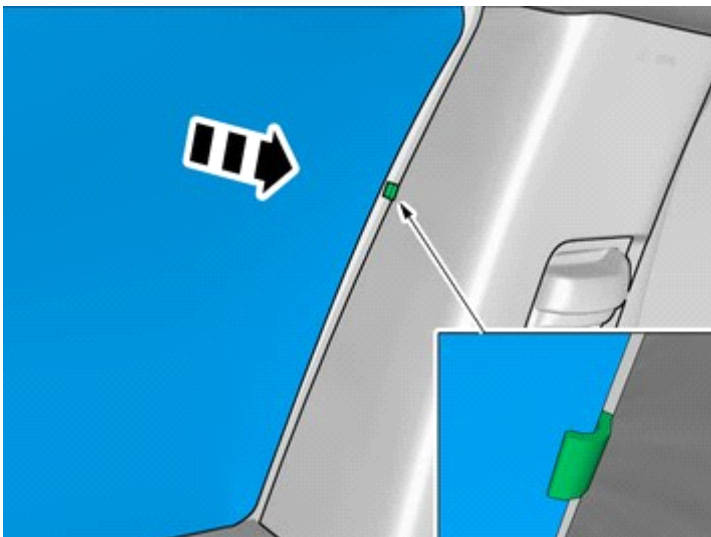

IMG-397783



Installation instructions, accessories

Volvo Car Corporation Gothenburg, Sweden

22

Repeat the steps when installing accessories on opposite side.
